

Hall (ground floor)



Dimensions:

- L 14m
- W 16m
- H 17m
- S 220m²

Facilities:

- LAC square and lake view
- Direct access to Sala teatro
- Exclusive catering area
- Brandable area
- Integrated video and sound system
- Dedicated office catering
- Dedicated wardrobe service
- Free delegate wi-fi

Capacity:
 conference: 200
 banquet: 120
 cocktail: 300

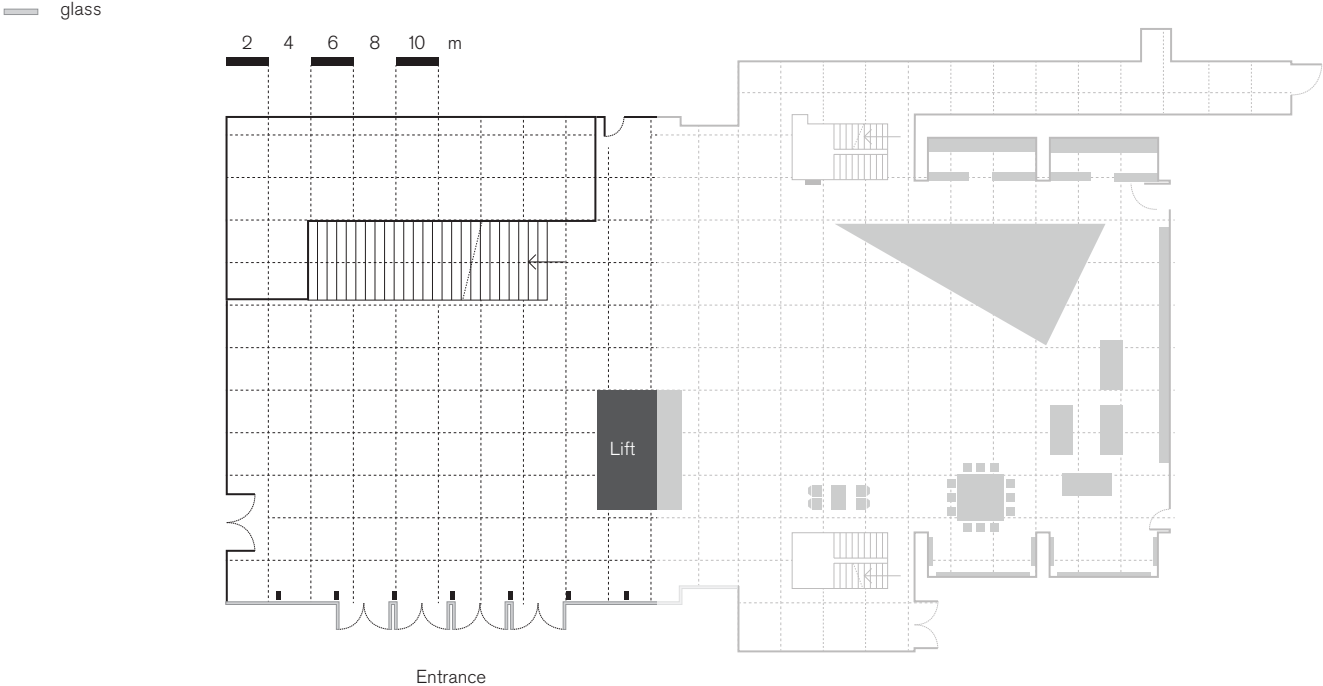

Conference

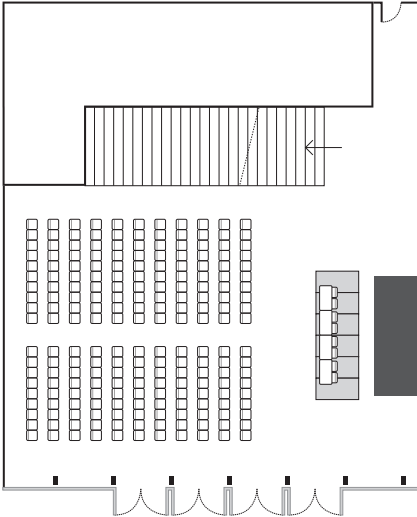

Banquet

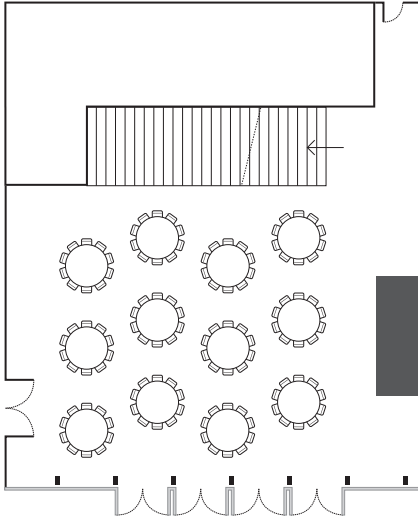

Cocktail

